



***BULLDOG***  
***FOUNDATION***  
***EST. 1950***

OUR MISSION

---

# ***BULLDOG FOUNDATION***

To create championship experiences for Fresno State student-athletes as they strive for excellence in the classroom, in competition, and in life.

---





## RED WAVE!

This past year, our football program rallied from an adverse start to win the Mountain West championship and the LA BOWL. In the process they personified many of the virtues we see within the people of the Central Valley. Their belief, determination, and resolve – qualities exemplified by all our 400 student-athletes – were truly inspiring.

Off the field, the Red Wave once again proved why you are the best fans on the west coast. We averaged 39,067 fans per game for the 2022 Season which led the Mountain West, was third nationally among all “Group of Five” institutions and was higher than 11 “Power Five” programs. It also represented our highest average since 2005 and our fourth straight year of increasing attendance, while attendance nationally is trending in the opposite direction. To say that the Red Wave represented our Valley extremely well during this incredibly important season, would be an understatement.

For all that you do in support of our pursuit of excellence, I genuinely thank you. But now is not the time to rest on our collective laurels. As the ever-changing landscape of intercollegiate athletics continues to evolve, it is imperative that we continue to work together to advance the cause and position of Fresno State to compete and succeed at the highest possible level.

Ascension requires investment. Your financial support of our student-athletes through the Bulldog Foundation is a direct investment in the future of our Valley. Together, we can lift Fresno State Athletics, and as a result our community, to heights never previously experienced.

I thank you in advance for your commitment in 2023 and, as always, **Go 'Dogs!**



**TERRY TUMEY**  
Director of Athletics



## INDEX

Where Your Contribution Goes	4
Club Red	6
Impact in Our Community	7
Meyers Champions Circle	8
The Green V Society	10
Football Tickets and Parking	12
Men's Basketball Tickets	14
Benefits Chart	15
Priority Points	16
Meet Our Team	17

***“We are so thankful for the passion of the Red Wave that continues year after year! It is so awesome to see the pride and tradition of Bulldog Football energize not only our team, but the university and community as well.”***



**Jeff Tedford**  
Football Head Coach



# Where Your Contribution Goes

Creating championship experiences for Bulldog student-athletes begins with funding scholarships. With 18 sports, 336 students receiving athletic aid and the increasing annual cost of attendance, the challenge to raise the needed scholarship dollars is greater than ever. Every contribution made helps us close the gap between what we raise each year and the total cost of scholarships.

**Every dollar given makes an impact towards our mission.**



**Amaya West,**  
Guard, Senior,  
Mesa, AZ

Breakdown of a Full Scholarship  
**California resident**, living off campus

Tuition and Fees	\$6,663
Books	\$800
Room and Board/Personal Expenses	\$16,994
<b>Total Cost of Attendance</b>	<b>\$24,457</b>

Breakdown of a Full Scholarship  
**Out of state/international**, living off campus

Tuition and Fees	\$18,543
Books	\$800
Room and Board/Personal Expenses	\$16,994
<b>Total Cost of Attendance</b>	<b>\$36,337</b>

**Estimated 2023 Total Cost of Scholarships**

**\$8 Million**



**3.29**  
Cumulative GPA  
for the School Year



**336**  
Student-Athletes  
receiving Athletic  
Scholarships



**145**  
Student-Athletes  
on Full Scholarship



**Top 3 Majors**  
1. Business Admin.  
2. Kinesiology-  
Exercise Science  
3. Psychology



**47**  
All-Conference  
Athletes



**248**  
Academic  
All-Conference  
Athletes



# CLUB RED

Club Red is a prestigious and exclusive group for former Bulldog student-athletes, coaches and trainers. Club Red is a one-of-a-kind community, bound forever by the Bulldog experience and dedicated to promoting the ever growing legacy of Fresno State Athletics. With 300+ members and counting, Club Red continues to represent Bulldog Born, Bulldog Bred throughout the years.

## Club Red in 2022:

**348** Members

Provided **16** full scholarships for Bulldog student-athletes

Donated **\$410,000** for scholarships



## Membership Includes:

- Up to four (4) discounted football/men's basketball season tickets
- Option to purchase two (2) All-Sports Passes for access to regular season Fresno State home events
- Two (2) admissions to BDF Club Red tailgates

**\$100+** Club Red Members receive associated BDF Membership Benefits

## Impact in our Community

*"Representing Fresno State as a student-athlete has been one of my greatest honors. Receiving a basketball scholarship gave me the opportunity to compete in the sport I love while earning my degree, with support from incredible coaches, faculty, and the amazing Fresno community. The skills I learned in the classroom and on the court are still with me today. I proudly support the Bulldog Foundation so current student-athletes can have championship experiences in their sports and their careers."*

**Tami Towle-Lundberg**  
Women's Basketball 1982-87

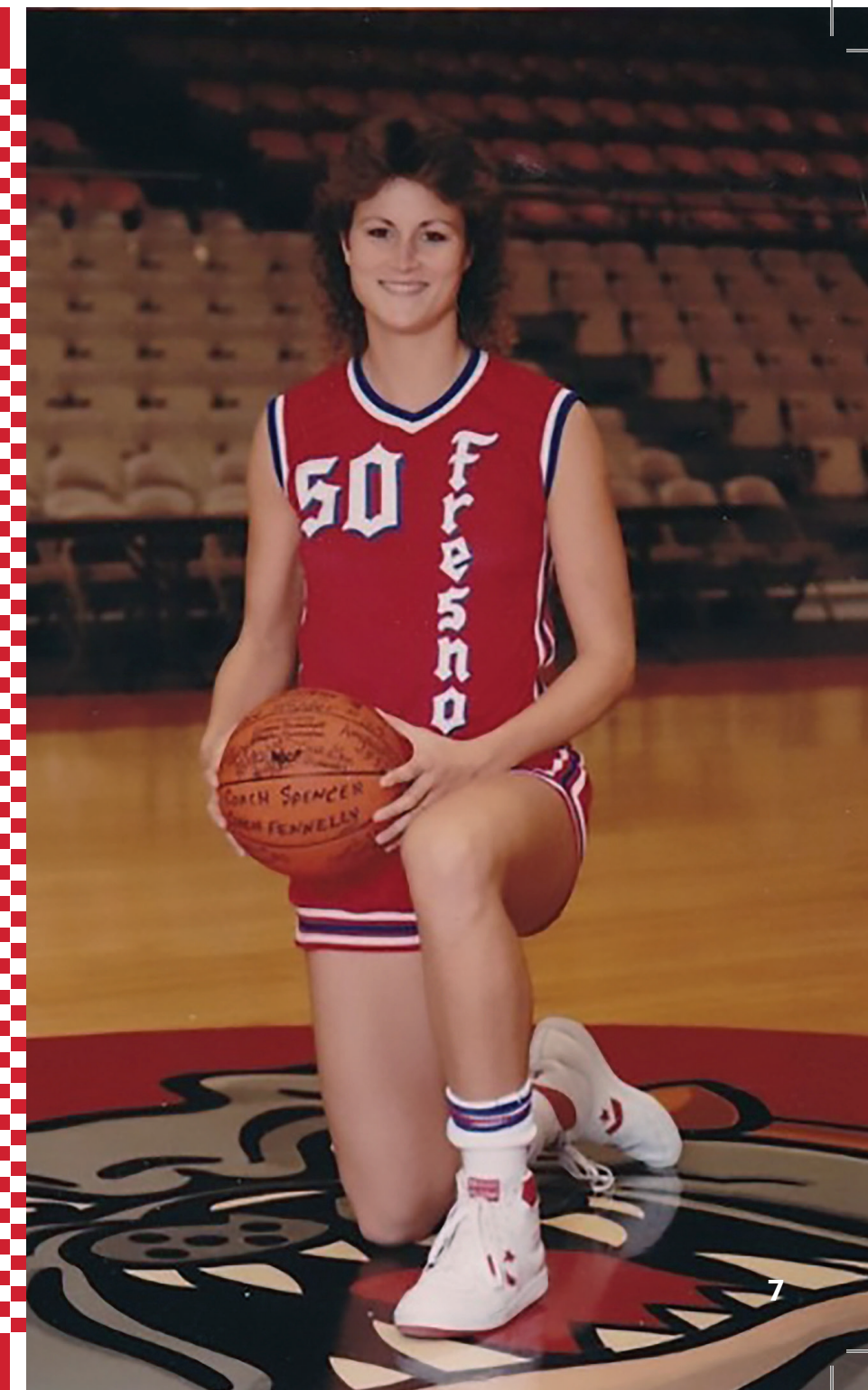





# MARVIN AND TISH MEYERS CHAMPIONS CIRCLE

The "Meyers Champions Circle" is an exclusive philanthropic giving society designed to maximize the resources for Bulldog student-athletes and improve the landscape of Fresno State Athletics. The Meyers Champions Circle is designed to honor donors whose major gift commitments rise above and beyond their annual giving requirements for seats and parking.

Membership in the Meyers Champions Circle requires a philanthropic "major gift" that can be directed to Capital Projects, Scholarship Endowments, or Sport Specific Gifts. Philanthropic donations of \$25,000 or more paid within a five-year period are recognized as "major gifts."

*A \$500K gift helped bring Morse Wittwer Sports Performance Center to life and will be stewarded through Membership in the Meyers Champions Circle.*



To learn more about the Meyers Champions Circle or other opportunities to impact Fresno State student-athletes, please contact the Bulldog Foundation at 559.278.7160 or visit [bulldogfoundation.org](http://bulldogfoundation.org).

**Chris and Michelle Morse,  
Ken and Kristi Wittwer**  
– Morse Wittwer Sports Performance Center

**Jeanne Contel**  
– Endowed Softball Scholarship

**Sue Hedman**  
– Endowed Women's Basketball Scholarship

**Ric and Annie Avila-Schultz**  
– Endowed Volleyball Scholarship

**Tom and Davita Miller**  
– Endowed Scholarship

**Carla Millar**  
– Endowed Baseball Scholarship

**Spike and Marjorie Biggers**  
– Endowed Track and Field Scholarship

**Julie Kerkochian**  
– Endowed Female Student-Athlete Scholarship

**Linda Duncan**  
– Endowed Football Scholarship

**Scott and Jody Barnes**  
– Endowed Women's Track and Field Scholarship

**Vin Whelan Family**  
– Football Fund for Excellence

**The Irwin Family**  
– Endowment Fund

**Pete and Donna Caldwell**  
– Men's Basketball Fund for Excellence

**Crosby Family Charitable Trust**  
– Student Athletes and Athletic Trainers Scholarships

**Valley Unique Electric**  
– Football Fund for Excellence

**Carl and Barbara Ueland**  
– Scholarship Fund and Capital Projects

**Helen Gigliotti**  
– Endowed Softball Scholarship

**Jim, Jeanette and Jason Martin**  
– Endowed Softball Scholarship

**Brandon and Nicole Eachus**  
– Men's Basketball Fund for Excellence

**Jami Hamel De La Cerda**  
– Endowed Baseball, Football, Women's Basketball, Track and Field Scholarships

**The Selling Family**  
– Football Fund for Excellence

**A J De Jager**  
– Football Fund for Excellence

**Blair, Church and Flynn Consulting Engineers**  
– Endowed Female Student-Athlete Scholarship

**Steve Moore**  
– Scholarship Fund

**Spencer Enterprises Inc.**  
– Scholarship Fund and Capital Projects

**Dr. Eric and Darlene Hanson**  
– Capital Projects

**Barry and Peggy Maas**  
– Capital Projects

**Panoche Creek Packing**  
– Capital Projects

**Ben and Carla Carroll**  
– Capital Projects

**Frank and Stacy Roque**  
– Scholarship Fund and Capital Projects

**Simeron Family**  
– Bulldog Built Endowment

**Pete and Caroline Simis**  
– Bulldog Built Endowment

**Doug and Tami Lundberg**  
– Endowed Women's Basketball Scholarship

**Chris and Kelly Woods**  
– Bulldog Built Endowment

**Richard and Bonda Aranas**  
– Endowed Women's Basketball/Volleyball Scholarship

**James and Irene Palmer**  
– Endowed Football Scholarship

**Katelyn Spencer and Colleen O'Brien**  
– Endowed Spirit Scholarships

*Memberships as of 12/31/2022*







# Join the Green V Society

## Hall of Fame \$50,000 and Above

Community Health System  
 Carl and Barbara Ueland  
 Chris and Kelly Woods

## President \$25,000 - \$49,000

Scott and Ruth Barcus  
 Ben and Carla Carroll  
 Gary and Sue Castro Family  
 Honor of Ara Hairabedian and Red Estes  
 Herb and Melinda Depp  
 Fresno First Bank  
 Bill and Lydia Gargan  
 Dr. Eric and Darlene Hanson  
 LinkUs  
 Steven Moore  
 Chris Morse and Ken Wittwer  
 Outback Materials  
 James G Parker Ins. Assoc.  
 Precision Civil Engineering Inc.  
 Rock 'n JK Farms  
 Frank and Stacy Roque  
 Bill and Linda Smittcamp  
 Spencer Enterprises Inc.  
 Table Mountain Rancheria  
 Tarlton and Son Inc.  
 Barry and Peggy Maas  
 Bill Tatham Sr. and Family  
 Thiesen Dueker Group  
 Valley Unique Electric  
 Valley Wide Beverage Co.

## First Team \$17,000 - \$24,999

Charles McMurray Co.  
 Fresno Valves and Casting  
 CENCAL Demolition Inc.  
 Jim, Jeannette and Jason Martin  
 Mike and Sue Martinusen  
 P R Farms  
 The Dalena Family

## Director \$10,000 - \$16,999

Richard and Joan Ahronian  
 Alert-O-Lite  
 Allenberg Cotton Co.  
 Brian Archer  
 Ardemis Piro  
 Ashwood Construction  
 Jace Baird / Alyson Baird Gorubec  
 Beck / Ruiz  
 Jerry Beckstead  
 Gene and Elizabeth Berberia  
 B-K Lighting  
 John and Lisa Bonadelle Jr.  
 Keeley and Judith Bramer  
 J and M Britton  
 David and Martin Britz  
 Builders Flooring Inc.  
 Dan Bushey  
 Caddis Properties LLC  
 Caglia Environmental  
 Dario Calderon  
 Dr. William and Joni Carveth  
 Central Valley Community Bank  
 Clawson Honda and Truck Center  
 Ron and Lisa Colburn  
 David Cruce

Gina Cuttone  
 Diamond Learning Center Inc.  
 DiBuduo and DeFendis Inc.  
 DiBuduo Fruit Co.  
 Diebert and Associates, CPAs  
 Direct Xpress Inc. - Drew and Jaz Gill  
 E. M. Tharp Inc.  
 Brandon and Nicole Eachus  
 EKC Enterprises  
 Fansler Restaurant Group  
 Fashion Furniture  
 Fitzgerald, Alvarez and Ciummo  
 Bart Flores  
 Gerald Forrest Family  
 Fowler Packing Co.  
 G-2 Farms  
 Harry and Ellie Gaykian  
 H. Markus and Co. Printing Services  
 Danette Hall  
 Mike Harris  
 Henry Hinkle  
 Jason Hollrah  
 Integrated Prescription Management  
 David and Rebecca Kaser  
 Kitahara Foundation  
 Christopher Marrero  
 Martin Marietta  
 Craig Martinez  
 Mike and Julie Martz  
 Sheri McBee  
 Mid Valley Services Inc.  
 Midland Tractor  
 Moore Grider and Company  
 Justin and Andrea Mostes  
 National Raisin  
 Pardini's Catering  
 Gordon Park / Bryan Stanhill

Penny Newman Grain Co.  
 Melvin Pereira  
 Perinatal Assoc of Central CA  
 Medical Grp Inc.  
 Quinn Company  
 RJO Produce Marketing  
 Reynolds Insurance Services Inc.  
 Sagaser Watkins and Wieland PC  
 Randall Sakamoto  
 San Joaquin Glass  
 Rod and Clarice Scarry  
 T. G. Schmeiser Co. Inc.  
 Richard Schultz  
 Jeff and Sharon Segars  
 Shannon Brothers  
 Mark and Daina Shuster  
 S-K Ranch  
 Robert Smittcamp  
 Snowden Enterprises Inc. / Kirk and Sheri Shermer  
 Spano Enterprises  
 Taylor Bros Inc.  
 John and Jodie Thomas  
 Trinity Fruit Sales  
 Tom Tsaris  
 Mark Turmon  
 Christian Ueland  
 Valley Air and Repair  
 Valley Iron Inc.  
 Van Beurden Insurance Services  
 Vin Whelan Family  
 Brett Visintainer  
 Walter R. Reinhardt Ins. Agency  
 Jim Winton / Winton Pharmacy  
 Darryl and Darin Zuber

**PRIDE OF THE VALLEY**

Bulldog student-athletes, coaches, and staff proudly wear the "Green V" to show their pride in representing the San Joaquin Valley.

The "Green V" Society represents a dedicated group of Fresno State donors who contribute \$10,000 or more in annual scholarship support to ensure Bulldog student-athlete success. "Green V" members receive the ultimate donor experience through a variety of exclusive benefits and special recognition.



# Football

## Minimum Per Seat Scholarship Contribution

Scholarship Contribution	Ticket Cost
\$400 <span style="color:red">■</span> *Level 1	\$286
\$250 <span style="color:darkblue">■</span> *Level 2	\$286
\$150 <span style="color:orange">■</span> *Level 3	\$286
\$50 <span style="color:green">■</span> Level 4	\$209
\$150 <span style="color:lightblue">■</span> Level 5	\$209
\$100 <span style="color:purple">■</span> Level 6	\$209
\$50 <span style="color:yellow">■</span> Level 7	\$209

\*New seats assigned in 2023 for sections 9-13 require the following minimum contribution per seat for consideration: 9 and 13 (\$250), 10 and 12 (\$500), 11 (\$1,000).

THE AMOUNTS INDICATE THE MINIMUM annual per seat support necessary in each section. Meeting the minimum amount DOES NOT GUARANTEE NEW seating in a particular section. Seat changes and additional/new season tickets, are assigned based on availability and all requests are filled on a Priority Point basis.

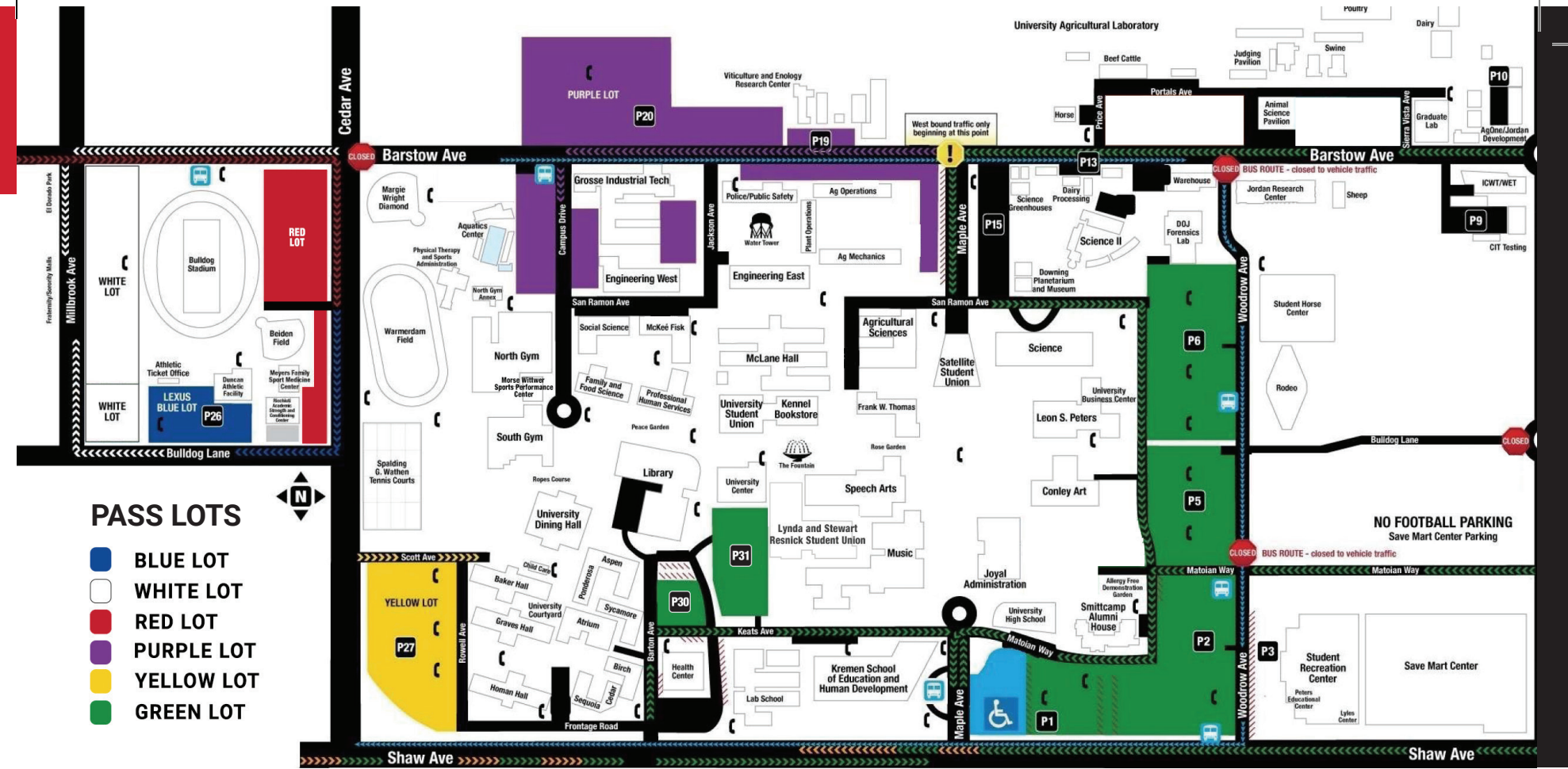

### RENEWING PARKING

Red and White lot auto and picnic pass holders must maintain their minimum required contribution to guarantee their same parking for 2023.

### PARKING REQUIREMENTS

For consideration, a minimum Bulldog Scholarship Fund contribution must be made:

Parking Lot	Minimum Donation	Season Pass Cost
<b>Picnic Red/White/Blue</b>	<b>\$10,000</b>	<b>\$600</b>
<b>Auto Red/White</b>	<b>\$2,500</b>	<b>\$120</b>
<b>Auto Yellow</b>	<b>\$500</b>	<b>\$120</b>
<b>Auto Purple</b>	<b>\$250</b>	<b>\$120</b>
<b>Auto Green</b>	<b>\$100</b>	<b>\$20</b>

Season picnic spaces are \$600 (includes two passes for space)



# Basketball

## Minimum Per Seat Scholarship Contribution



Scholarship Contribution	Ticket Cost	Scholarship Contribution	Ticket Cost
<b>\$500</b>	<b>Level 2 \$410</b>	<b>\$250</b>	<b>Level 4 \$199</b>
<b>\$500</b>	<b>Level 3 \$280</b>	<b>\$100</b>	<b>Level 5 \$199</b>
		<b>\$50</b>	<b>Level 6 \$199</b>
		<b>\$50</b>	<b>Level 7 \$99</b>

\*Please contact the Bulldog Foundation for more information

# Benefits Chart

	Former Student-Athletes							Green V Society Levels				
	Club Red \$50	Red Wave \$100	Spirit \$250	Captain \$500	Champion \$1,000	Victory \$1,750	MVP \$2,500	All-American \$5,000	Director \$10,000	First Team \$17,000	President \$25,000	Hall of Fame \$50,000
Tax Deduction*	●	●	●	●	●	●	●	●	●	●	●	●
Online Recognition	●	●	●	●	●	●	●	●	●	●	●	●
Bulldog Brief News	●	●	●	●	●	●	●	●	●	●	●	●
Special Bulldog Gift	●	●	●	●	●	●	●	●	●	●	●	●
Football Parking Access		●	●	●	●	●	●	●	●	●	●	●
Bulldog Plaque+				●	●	●	●	●	●	●	●	●
All Sports Admissions**							2	4	4	6	6	6
Special Event Invitations								●	●	●	●	●
VIP Football Parking Access									●	●	●	●
Green V Gift									●	●	●	●

\*Any part of the Bulldog Scholarship Fund contribution that is required for seating is not tax deductible. Please consult your tax advisor for more information.

\*\* Included with membership upon request. Valid for all paid sports except Football and Men's Basketball.

+Eligible after second year

If alterations are made to our program that affects benefits, the Bulldog Foundation reserves the right to make adjustments at that time.



# Priority Points

The Priority Point System recognizes Bulldog Foundation Members and is used to determine priority for season ticket and parking assignments, away game football tickets and post-season events including bowl games. Our goal is to equitably recognize support made through the Bulldog Foundation and to reward those who have helped Fresno State student-athletes.

## Current Year Support (5 points per \$100)

Scholarship Fund points are based on current year pledge and all non-scholarship points are based on payments received in the 12 months prior to point calculation.

## Historical Giving (\$) (2 points per \$100)

All Bulldog Foundation support from 1992 not included in Current Year category.

## Football Suites

Points are awarded for total suite cost less ticket value in the Current Year Support and Historical Giving categories (dating back to 2005).

## Historical Giving (Years) (2 points per year)

Points are assigned based on consecutive years supporting the Scholarship Fund from current year back to 1992.

## Season Tickets Purchased (5 points per sport)

Current Year purchase in any sport.

## Former Bulldog Student-Athlete (50 points)

One-time points for letter winners.

## Former Volunteers (2 points per year)

Points per year of volunteering on BDF Fund Drive.

## Important Notes

- Our records allow us to recognize support from 1992 to present. Member ranking is based on Priority Point total as long as all minimum support requirements for tickets and/or parking are met.
- Customers must have a current Red Wave (\$100) or higher membership in the Scholarship Fund to accumulate points.
- Priority Points are calculated prior to seating assignments and special events.
- Priority Points are non-transferable.
- If a member cancels their current Bulldog Foundation Membership they have no points. If they rejoin at a later date they receive all historical points for which they are eligible.

# Meet Our Team



**Terry Tumey**  
Director of Athletics



**Tim Collins**  
Senior Associate Athletics  
Director for Development  
559.278.8256  
[tcollins@mail.fresnostate.edu](mailto:tcollins@mail.fresnostate.edu)



**Terry Johnson**  
Executive Director  
559.278.6132  
[terryj@mail.fresnostate.edu](mailto:terryj@mail.fresnostate.edu)



**Phil Neslund**  
Director of Development,  
Major Gifts  
559.278.1180  
[pneslund@mail.fresnostate.edu](mailto:pneslund@mail.fresnostate.edu)



**Gena Strang-Behrens**  
Director of Development  
and Alumni Relations  
559.278.2099  
[gbehrens@mail.fresnostate.edu](mailto:gbehrens@mail.fresnostate.edu)



**Judy Lea**  
Assistant Director of Development,  
Donor Relations and Events  
559.278.4112  
[jlea@mail.fresnostate.edu](mailto:jlea@mail.fresnostate.edu)



**Madelynn Garcia**  
Development Coordinator  
559.278.2768  
[madelynn Garcia@mail.fresnostate.edu](mailto:madelynn Garcia@mail.fresnostate.edu)



**Nick Sabbatini**  
Development Coordinator  
559.278.1045  
[nsabbatini@mail.fresnostate.edu](mailto:nsabbatini@mail.fresnostate.edu)



**Patrick Ogle**  
Development Officer  
559.278.6134  
[patricko@mail.fresnostate.edu](mailto:patricko@mail.fresnostate.edu)





**Megan Barbeau**  
Administrative Assistant  
559.278.6135  
[mbarbeau@mail.fresnostate.edu](mailto:mbarbeau@mail.fresnostate.edu)



**Ronell Moore**  
Accounting Specialist  
559.278.6202  
[ronellmoore@mail.fresnostate.edu](mailto:ronellmoore@mail.fresnostate.edu)

## Follow the Bulldogs

Sign up for Fresno State Vmails and follow    [@fresnostatebdf](https://www.instagram.com/fresnostatebdf) for the latest information from the Bulldog Foundation.







***BULLDOG  
FOUNDATION  
EST. 1950***

P.O. Box 26267, Fresno, CA 93729

559.278.7160

*bulldogfoundation@mail.fresnostate.edu*

---

***bulldogfoundation.org***